

## Miscellaneous

**How to get to miscellaneous settings:** Open Left Main Menu → Settings → Miscellaneous.

Description of miscellaneous settings items:

- **Clear cache data** - Option to erase application cache data.
- **Import/export settings** - Option to import or export application settings. Useful in a case of migrating from one device to another or in a case of resetting the application.
- **Reset settings** - Option to reset settings to defaults.
- **Send anonymous crash logs** - Option to turn on/off automatic anonymous information about application crashes, that allows us to fix crashes and improve the application. Requires a restart of application to take effect.
- **Send anonymous usage stats** - Option to turn on/off automatic anonymous usage statistics, that allows us to improve the application. Requires a restart of application to take effect.

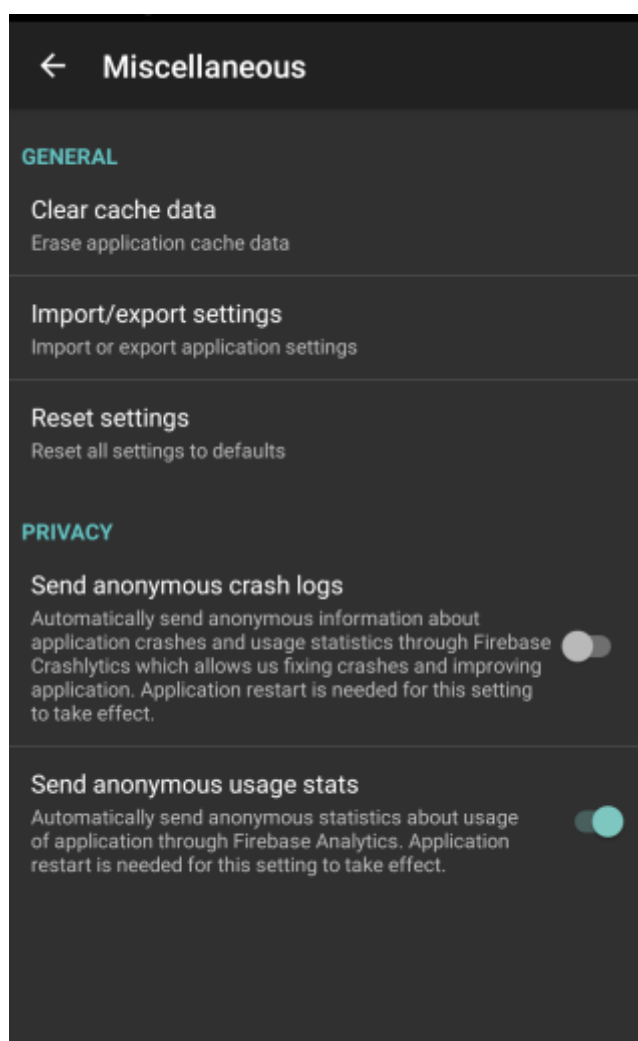

Last  
update: docs:settings\_miscellaneous https://docs.vecturagames.com/gpxviewer/doku.php?id=docs:settings\_miscellaneous&rev=1658928337  
2022/07/27 13:25

---

From:  
<https://docs.vecturagames.com/gpxviewer/> - **GPX Viewer User Guide**

Permanent link:  
[https://docs.vecturagames.com/gpxviewer/doku.php?id=docs:settings\\_miscellaneous&rev=1658928337](https://docs.vecturagames.com/gpxviewer/doku.php?id=docs:settings_miscellaneous&rev=1658928337)

Last update: **2022/07/27 13:25**

